

THE HOLIDAYS COLLECTION



35 McArthur Drive WOOLLAMIA NSW

4  2  4 

Located just minutes from the pristine waters of Jervis Bay this picture perfect rural property offers the best of both worlds, you can have a sea and tree change all in one.

Land Size : 23100 sqm
View : <https://www.sales.holidayscollection.com.au/sale/nsw/shoalhaven/woollamia/residential/house/5717726>

- *Immaculate four bedroom, double bathroom home.
- *Light filled living with loads of space throughout.
- *Raked ceilings with exposed timber beams.
- *Big country kitchen, plenty of room for entertaining.
- *Two double garages plus space for boats and vans.
- *Elevated wraparound timber deck, lovely outlook.

Less than 5 minutes drive to the centre of Huskisson. With cafes, restaurants, beautiful beaches, dolphin & whale watching tours what more could you want?

All enquiries contact Scott Morton on 0405 227 987 or Email scott@southcoastproperties.com.au



Craig McIntosh
02 44430242



LIVING AREA 10.7m x 7.3m = 78.11sqm

GARAGE 7.3m x 7.3m = 53.29sqm

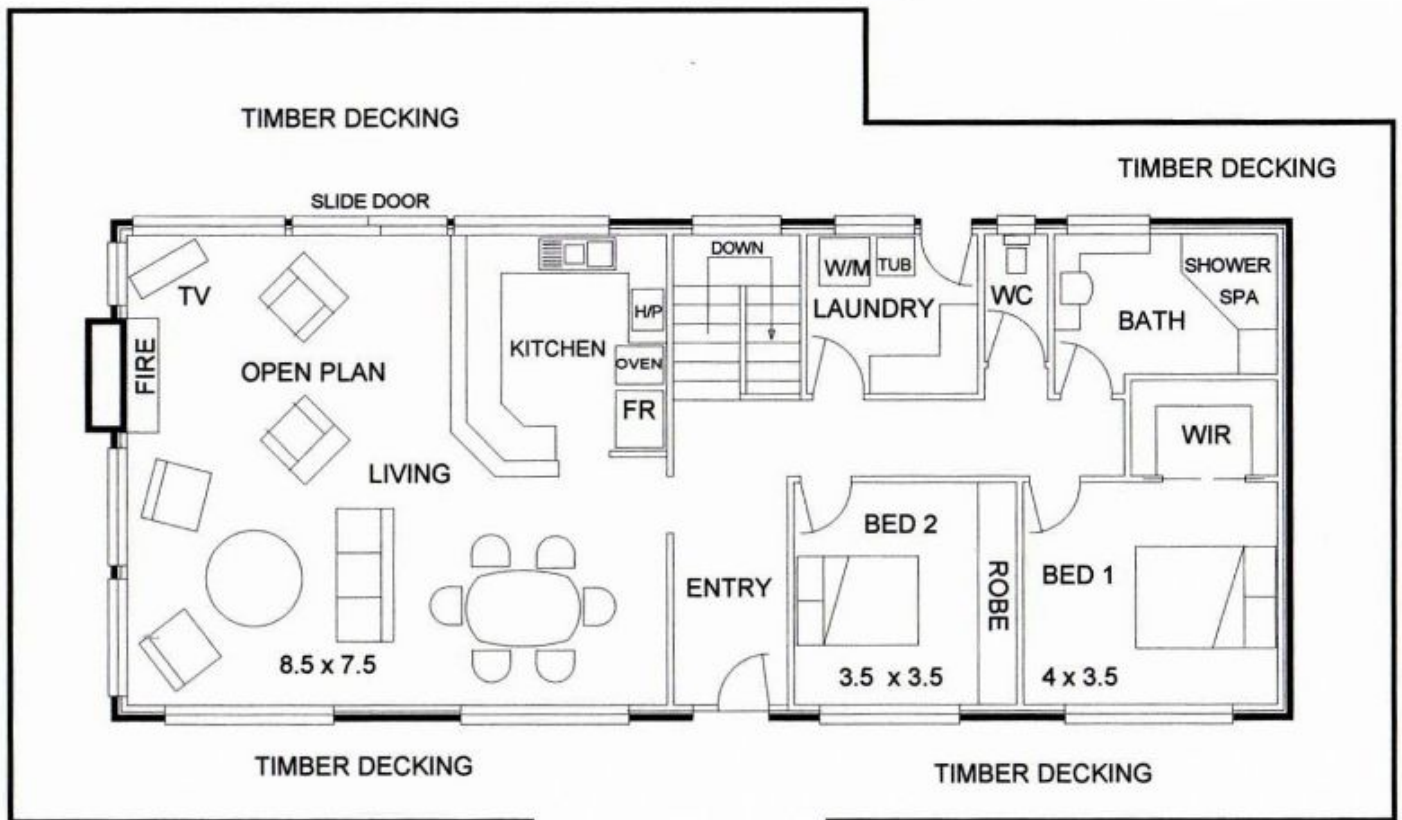

LIVING AREA 18m X 7.5m = 135sqm

DECKING AREA = 129sqm

DECKING

