

THE HOLIDAYS COLLECTION



244 Elizabeth Drive Vincentia NSW

2 1 1

244 Elizabeth Drive is a rare waterfront block, located in a line of houses that are either newly built or fully refurbished.

The property also has a great setting - up high above the cycle path, shielded for privacy by native trees, yet with a lovely north east view that takes in a small beach and the waters of Jervis Bay. The position will pleasantly surprise you - with the white sand of Jervis Bay only 30 metres from your boundary!

Vincentia Village shopping centre is also only a level 5 minute walk away and Huskisson is a 5 minute drive.

The current 2 bedroom fibro cottage has a single lock up garage attached, as well as a separate store room. The cottage could be refurbished to earn some holiday rental income for a holding period - probably best positioned as what would be a very unique, waterfront, couples only

Price : \$ 1,500,000

Land Size : 647 sqm

View : <https://www.sales.holidayscollection.com.au/sale/nsw/shoalhaven/vincentia/residential/house/5717821>



Craig McIntosh
02 44430242

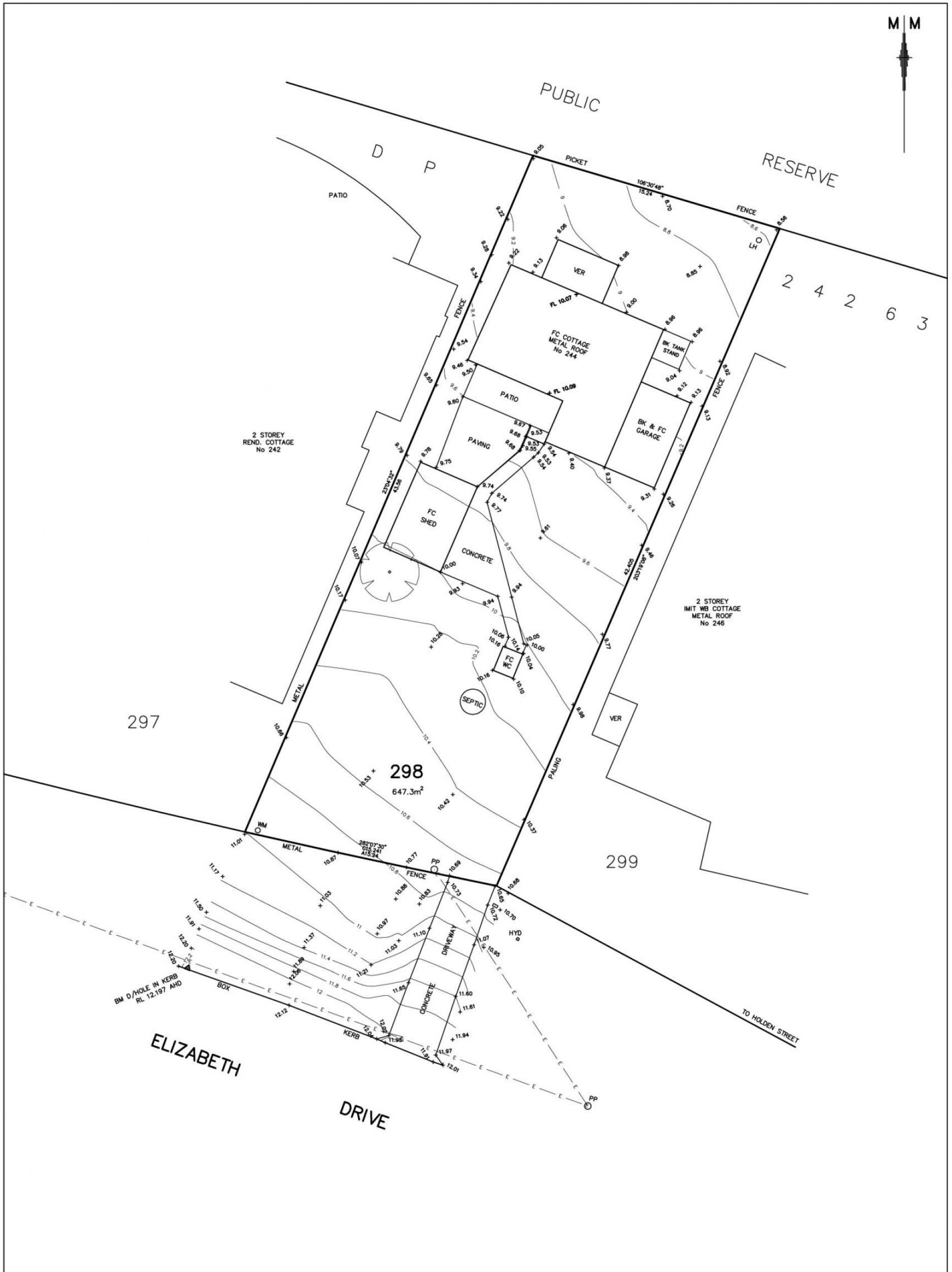

leslie & thompson
SURVEYORS
 52 Berry Street, VIC 3048
 PO Box 778 North Melbourne, VIC 3041
 Tel: 03 4422 1233
 Fax: 03 4422 1332
 www.lesliethompson.com.au

AHD DETAIL SURVEY
 LOT 298 DP 24263
 No 244 ELIZABETH DRIVE, VICINCENTIA
 FOR : GREEN

SURVEYOR	GB	1:100 A1
DRAWN	JM	1:200 A3
DATE	7 MAR 2016	
DATUM	AHD	SHEET OF 1
ORIGIN	SSM 69034	REF 12672.1
RL	10.36	REV 1

NOTES
 1. THIS SURVEY IS FOR CONTOUR PURPOSES ONLY AND THE BOUNDARIES OF THE SUBJECT PROPERTY HAVE NOT BEEN INVESTIGATED.
 2. VISIBLE SERVICES ONLY ARE SHOWN. SERVICE DETAILS SHOULD BE CONFIRMED WITH THE RELEVANT SERVICE AUTHORITIES PRIOR TO DESIGN AND CONSTRUCTION.
 3. CONTOURS ARE INDICATIVE OF SURFACE TOPOGRAPHY ONLY AND HAVE BEEN INTERPOLATED FROM THE SPOT LEVELS SHOWN.

DATE	AMENDMENT

